

NVENT LENTON PLUS AND NVENT LENTON PLUS 200

THE REBAR SPLICING SPECIALISTS FOR NUCLEAR CONSTRUCTION

Pre-Qualified as
an Ultimate Rebar
Connector



FEATURES

- LENTON Plus splicing systems are designed to break the reinforcing bar remote from the rebar connector.
- LENTON Plus is available in Standard (A12), Position (P14L), and nVent LENTON Terminator (D14/D16) styles. Other nVent LENTON styles upon request.
- LENTON Plus splicing systems meet or exceed building code and DOT requirements. This includes but is not limited to CalTrans Ultimate, ACI 318 TYPE 2, IBC, ACI 349, ACI 359, AASHTO, and US Army Corp of Engineers.
- Terminator (D14/D16) is pre-qualified by various DOTs for use as Headed Bar Reinforcement and meets the requirements of ACI 318, ASTM A970, and AC 347.

U.S. Patent Nos. 6,880,224 7,509,048

LENTON Plus Project References

Fantasy Harbour Bridge, Myrtle Beach, SC USA

Galena Creek, Reno, NV USA

Marmaray Tunnel, Istanbul, Turkey

Santa Clara River Bridge, Oxnard, CA USA

Sellafield BNFL, Seascale, UK

Tacoma Narrows Bridge, Tacoma, WA USA

NVENT LENTON PLUS MECHANICAL REBAR SPLICING SYSTEMS ACHIEVE BAR BREAK REMOTE

nVent, the worldwide manufacturer of the widely accepted Mechanical Rebar Splicing System, also offers the patented LENTON Plus and patent pending LENTON Plus 200 splicing systems. These systems address critical applications where the mechanical rebar connector is required (by design parameters) to force failure into the parent reinforcing bar, remote of the rebar connector. This most stringent connector demand is defined by some State Department of Transportation (DOT) guidelines as the Ultimate Rebar splicing classification.

Both systems utilize the same proven traditional nVent LENTON taper threaded concept, but with a slight variation. In order to reliably achieve this high performance the threaded end of the rebar must be strengthened. LENTON Plus achieves this by hydraulically straightening (cold working) the end of the rebar prior to threading. The slightly reconfigured bar end is then placed into a standard nVent LENTON threading machine and a traditional nVent LENTON taper thread is machined onto the rebar. LENTON Plus 200 achieves the added strength by induction heat treating the end of previously threaded rebar through a tightly monitored and controlled process.

LENTON Plus is generally used for smaller bars (#4 through #11) and LENTON Plus 200 is used on larger bars (#10 through #18). Both systems are used in conjunction with the standard coupler (A12), the position coupler (P14L) and with the Terminator (D14/D16). While the nVent LENTON standard and position couplers are designed to mechanically connect two reinforcing bars together, the Terminator (D14/D16) is designed for headed bar reinforcement applications.

LENTON Plus and LENTON Plus 200 have been pre-qualified by various DOTs as an Ultimate Rebar splicing system. In addition, Terminator (D14/D16) is pre-qualified as a Headed Bar Reinforcement (end anchor) and meets the requirements of the current ASTM A970.

The LENTON Plus rebar splicing systems are designed to offer engineers and contractors, when required, an ultimate bar break remote splicing option. The nVent LENTON (A12/P14L) and Terminator (D14/D16) are extensions to the existing nVent ERICO mechanical rebar splicing systems and headed anchors. For ACI and IBC Types 1 & 2 applications we offer our standard coupler families (A2/P9) and standard Terminator (D6).

nVent has experienced staff and resources available to help you select a splicing or anchor system to meet your needs. Contact your local representative for independent testing data, product samples, availability or to discuss specific applications.

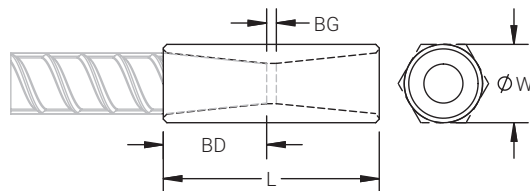

NVENT LENTON PLUS STANDARD BAR-TO-BAR COUPLERS – A12

Designed to splice the same diameter bars where one bar can be rotated.

Part Number	Rebar Size			Hex Width W	Diameter Ø	Length L	Bar Depth BD	Bar Gap BG	Unit Weight	LENTON Plus	LENTON Plus 200
	Metric	US	Canada								
EL12A12	12	4	10	0.69		1.96	0.73	0.50	0.1	✓	
EL16A12	16	5	15	0.88		2.41	0.96	0.49	0.3	✓	
EL20A12	20	6	20	1.06		3.41	1.37	0.67	0.6	✓	
EL22A12	22	7		1.19		3.60	1.46	0.68	0.8	✓	
EL25A12	25	8	25		1.38	3.80	1.57	0.66	1.0	✓	
EL28A12	28	9	30		1.50	3.97	1.65	0.67	1.1	✓	
EL32A12	32	10			1.75	4.23	1.78	0.67	1.7	✓	✓
EL36A12	36	11	35		1.88	4.76	2.04	0.68	2.0	✓	✓
EL43TA12	43	14	45		2.25	6.22	2.60	1.02	3.8		✓
EL57TA12	57	18	55		3.00	7.57	3.28	1.01	8.3		✓

Bar dimensions and weights listed may vary by region. Coupler sizes not shown may be available by special order. Contact your nVent representative for more information on special sizes.

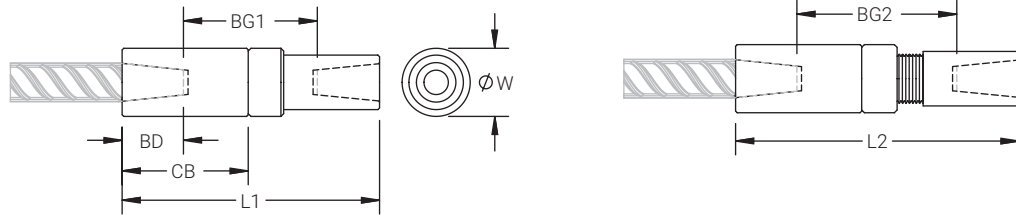

NVENT LENTON PLUS POSITION COUPLER – P14L

P14L Position Couplers are for use with curved, bent, or straight bars, when neither bar can be rotated and where the ongoing bar is free to move in its axial direction.

Part Number	Rebar Size			Diameter Ø	Length 1 L1	Length 2 L2	Bar Depth BD	Bar Gap 1 BG1	Bar Gap 2 BG2	Coupler Body CB	Unit Weight	LENTON Plus	LENTON Plus 200
	Metric	US	Canada										
EL12P14L	12	4	10	1.00	3.85	4.07	0.73	2.36	2.56	1.82	1.23	✓	
EL16P14L	16	5	15	1.38	4.39	4.62	0.96	2.52	2.72	2.13	1.03	✓	
EL20P14L	20	6	20	1.38	5.98	6.34	1.37	3.23	3.58	2.98	1.92	✓	
EL22P14L	22	7		1.75	6.31	6.67	1.46	3.39	3.74	3.15	3.07	✓	
EL25P14L	25	8	25	1.75	6.64	6.99	1.57	3.50	3.86	3.37	2.84	✓	
EL28P14L	28	9	30	2.00	6.90	7.25	1.65	3.58	3.94	3.54	3.78	✓	
EL32P14L	32	10		2.25	7.55	7.91	1.78	4.02	4.37	3.79	5.41	✓	✓
EL36P14L	36	11	35	2.50	8.13	8.48	2.04	4.06	4.41	4.13	6.87	✓	✓
EL43TP14L	43	14	45	3.00	10.79	11.41	2.60	5.59	6.22	5.60	13.33		✓
EL57TP14L	57	18	55	4.00	12.61	13.23	3.28	6.06	6.69	6.59	26.25		✓



NVENT LENTON PLUS TERMINATOR – D14

The Terminator is an oversized half coupler that secures to the end of reinforcing steel effectively replacing hooked rebar and reducing congestion.

Part Number	Rebar Size			Diameter 1 Ø1	Diameter 2 Ø1	Length 1 L1	Length 2 L2	Unit Weight	LENTON Plus	LENTON Plus 200
	Metric	US	Canada							
EL12D14	12	4	10	1.75		0.72		0.5	✓	
EL16D14	16	5	15	2.00		0.94		0.9	✓	
EL20D14	20	6	20	2.50		1.37		1.8	✓	
EL22D14	22	7		2.75		1.46		2.3	✓	
EL25D14	25	8	25	3.25		1.57		3.2	✓	
EL28D14	28	9	30	3.75	1.66	1.65	0.98	2.3	✓	
EL32D14	32	10		4.00	1.87	1.78	0.98	3.1	✓	✓
EL36D14	36	11	35	4.50	2.08	2.04	0.98	5.0	✓	✓
EL43TD14	43	14	45	5.35	2.50	2.64	1.33	9.1	✓	✓
EL57TD14	57	18	55	7.13	3.13	3.31	1.63	21.5		✓

Diameter exceeds 10X (net 9X) bar area requirements of ASTM A970 and ACI 318.



PLUS TERMINATOR – D16

The Terminator is an oversized half coupler that secures to the end of reinforcing steel effectively replacing hooked rebar and reducing congestion.

Part Number	Rebar Size			Diameter 1 Ø1	Diameter 2 Ø1	Length 1 L1	Length 2 L2	Unit Weight	LENTON Plus	LENTON Plus 200
	Metric	US	Canada							
EL12D16	12	4	10	1.38		0.73		0.3	✓	
EL16D16	16	5	15	1.50		0.94		0.4	✓	
EL20D16	20	6	20	1.88		1.38		0.9	✓	
EL22D16	22	7		2.00		1.48		1.1	✓	
EL25D16	25	8	25	2.25		1.57		1.5	✓	
EL28D16	28	9	30	2.75		1.65		2.4	✓	
EL32D16	32	10		3.00		1.79		3.1	✓	✓
EL36D16	36	11	35	3.25		2.05		4.0	✓	✓
EL43TD16	43	14	45	4.00	2.50	2.64	0.98	6.7	✓	✓
EL57TD16	57	18	55	5.13	3.00	3.31	0.98	12.7		✓

Diameter exceeds 5X (net 4X) bar area requirements of ASTM A970 and ACI 318.



Our powerful portfolio of brands:

CADDY ERICO HOFFMAN RAYCHEM SCHROFF TRACER

Contact nVent for availability.

For a copy of IAPMO-UES Report 0188, Report 0129, or information on how to specify the LENTON Plus Rebar Splicing System, visit nVent.com/LENTON

AAASHTO is a registered trademark of American Association of State Highway and Transportation Officials.

ACI is a registered trademark of American Concrete Institute.

ASTM is a registered trademark of ASTM International.

IAPMO is a registered trademark of the International Association of Plumbing & Mechanical Officials.

IBC and ICC are a registered trademarks of International Code Council.

WARNING: nVent products shall be installed and used only as indicated in nVent's product instruction sheets and training materials. Instruction sheets are available at nVent.com/LENTON and from your nVent customer service representative. Improper installation, misuse, misapplication or other failure to completely follow nVent's instructions and warnings may cause product malfunction, property damage, serious bodily injury and/or death, and void your warranty.

©2018 nVent. All nVent marks and logos are owned or licensed by nVent Services GmbH or its affiliates. All other trademarks are the property of their respective owners.

nVent reserves the right to change specifications without notice.

LENTON-DS-C1189S-C74LT14NAEN-EN-1805